



**ALAN PRE-FAB BUILDING CORPORATION**

Contractor's License #269618

Since 1966

17817 Evelyn Avenue, Gardena CA 90248-3735 U.S.A.

Tel: 1 310 538 0333

Email: [apsales@apb90248.com](mailto:apsales@apb90248.com)

Sales Rep:

**DATE:** 1/1/2026

**PROPOSAL NO:** 44462 - 4x6

**Attn:** Customer  
Company  
Address

**Phone:** 000.000.0000  
**Project:** 4x6 Deluxe GH with AC-Heat  
**Ofc/Cell:** 000.000.0000  
**e-mail:** [anynome@anydomain.anyext](mailto:anynome@anydomain.anyext)

City, State Zip

**We appreciate the opportunity to quote on your requirements:**

- |   |            |                    |
|---|------------|--------------------|
| Project: 4x6 Deluxe GH with AC-Heat   | Wood Frame | Type V-NR          |
| -Basic Building. Skid Mounted   | 2x6 floor  | 16" on center      |
| -Interior - Lined   | 2x4 walls  | 16" on center      |
| -Insulation- R-11 Walls, R-19 Ceiling   | 2x6 roof   | 24" on center      |
| -1/4" Birch wood interior paneling  | 4x6 skids  | set 48" out to out |
| -1/2" taped and painted gypsum board ceiling  |            |                    |
| -1/8" V.C. Floor tiles, Armstrong over 3/4" T&G Plywood decking                                 |            |                    |
| -5/8" T-111 exterior siding. Painted White with pre-painted Brown metal trimout.                |            |                    |
| -Lo Profile roof design. .024 blanket aluminum sheet roofing over 3/8" CDX plywood underlayment |            |                    |
- 1 -3-0x6-8 Steel clad entry door with glass insert, lever passage entry, deadbolt lock. Brown.
  - 1 -Windows - 3-0x2-6 Dual-Glazed sliding windows, clear glass
  - 2 -Windows - 4-0x2-6 Dual Glazed sliding windows, clear glass
  - 1 -Electrical Subfeed Load Center, 125 Amp, Single Phase, snap in circuit breakers
  - 2 -Duplex receptacles One plug set above counter top.
  - 1 -Light switch
  - 1 -Energy efficient LED light fixture
  - 1 -Air Conditioner/Heater, sleeve-mount, room unit, 120V, frame, wiring & installation
  - 4 -LF Countertop. 12" deep. Melamine over 2x4 support. Top of counter set at 40" above finished floor.

<b>PURCHASE PRICE:</b>	<b>\$8,450.00</b>			
<b>Shipping:</b>	<b>Not Incl.</b>	FOB: Gardena, CA 90248	Shipping to site to be added	
<b>Sales Tax:</b>	<b>\$887.25</b>	10.500%		
<b>Sub-Total:</b>	<b>\$9,337.25</b>			

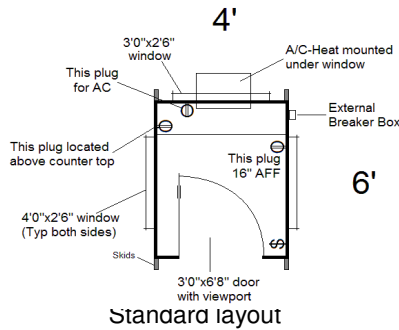

Note:  
This is a stand alone, non-permitted structure.  
Plans/Engr and/or DOH inspection not included.

Items not included: Any features not specifically listed in proposal.

**PAYMENT TERMS:** \$3,500.00 Down. \$5,837.25 Due on or before delivery  
Add 3.5% to any total due if paying by credit card

This proposal may be revised or withdrawn by us after: Thirty days from proposal date

Acceptance: The specifications, conditions, and payment terms are agreed to: By: X

Please return one copy. Order will be commenced upon our receipt of signed proposal, and deposit (if required).